

Application:Free standing,pedestal mounted eye/face wash.Water flow is activated by either flag handle or foot treadle.

Spray Head Assembly:Two spray heads.Each head has a dust cover,internal flow control and filter to remove impurities from the water flow.

Valve:3/8"IPS chrome plated brass stay-open ball valve.Valve is activated by flag handle or foot treadle. Unit remains in operation until handle is returned to closed position.

Eye Wash Bowl:11-1/2"diameter. Bowl is ABS plastic.

Pipe and Fittings: Schedule1" and 1/2" galvanized steel.Furnished with green polyethylene covers for vertical piping for corrosion resistance.

Supply:1-1/4" NPT female inlet.

Waste:1-1/4"NPT female outlet.

Quality Assurance: Valve,bowl and spray head assembly is factory assembled.

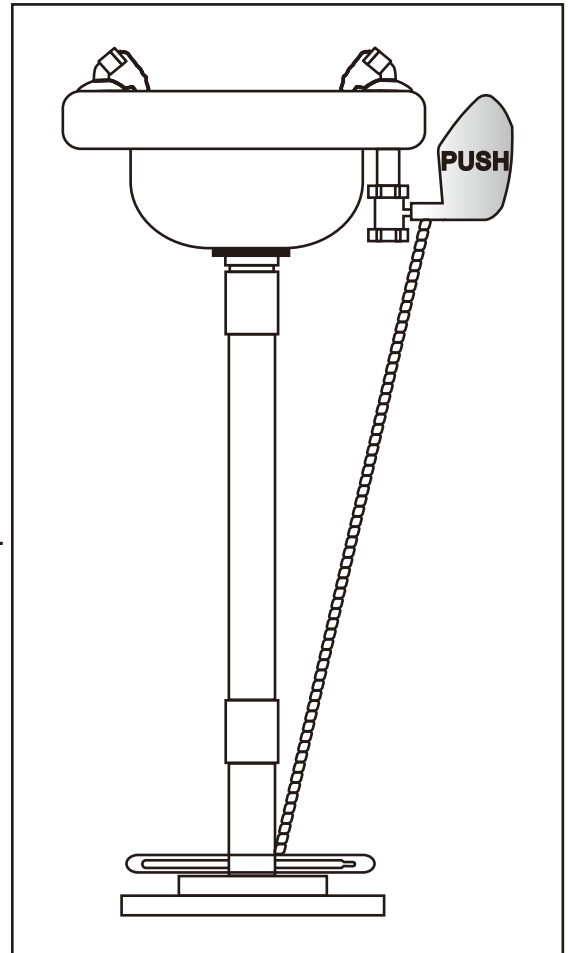

Product Feature

- Controlled,low velocity flow completely rinses eyes and face is not injurious to user.
- Eye washer unit deliver 11.5 liters of water per minute.
- Outlet heads position meets 89/686/EEC, ANSI Z358.1-2009,EN 15154-1:2006 & EN 15154-2:2006.
- Protect spray heads from airborne contaminants.
- Valve actuator are easy to locate and readily accessible to user.
- Hands-free stay open valve activate within one second.
- Connect unit to uninterruptible water supply delivering at 3 GPM.

Eye Washer Details Parts Listing

	Part Name	Description	Pieces
A	Basin	ABS Plastic	1 piece
B	Drain Plate	Drain plate, Cupped washer, and Gasket (Fully Mounted with Part A)	1 each (total 3 pieces)
C	Spray Head	Chrome plated brass fittings (Fully Mounted with Part A)	2 pieces
D	Eyewash Shank	3/8" Brass shank (Fully Mounted with Part A)	1 piece
E	Dust Cover	Plastic dust cover (Fully Mounted with Part A)	2 pieces
F	Ball Valve	Chrome plated brass valves (Fully Mounted with Part A)	1 piece
G	Basin Connection Pipe	Galvanized Steel (Fully Mounted with Part K)	1 piece
H	Hand Control Panel	Cast Iron (Fully Mounted with Part K)	1 piece
I	Foot Control Panel	Plastic (Fully Mounted with Part K)	1 piece
J	Connection Chain	Stainless Steel (Fully Mounted with Part K)	1 piece
K	Pipe Pack	Galvanized Steel (Fully Mounted with Part K)	3 pieces
L	Waste Receptors	Galvanized Steel (Fully Mounted with Part K)	1 piece
M	Floor Flange	Aluminum Iron (Fully Mounted with Part K)	1 piece
N	Hose	Hose	1 piece

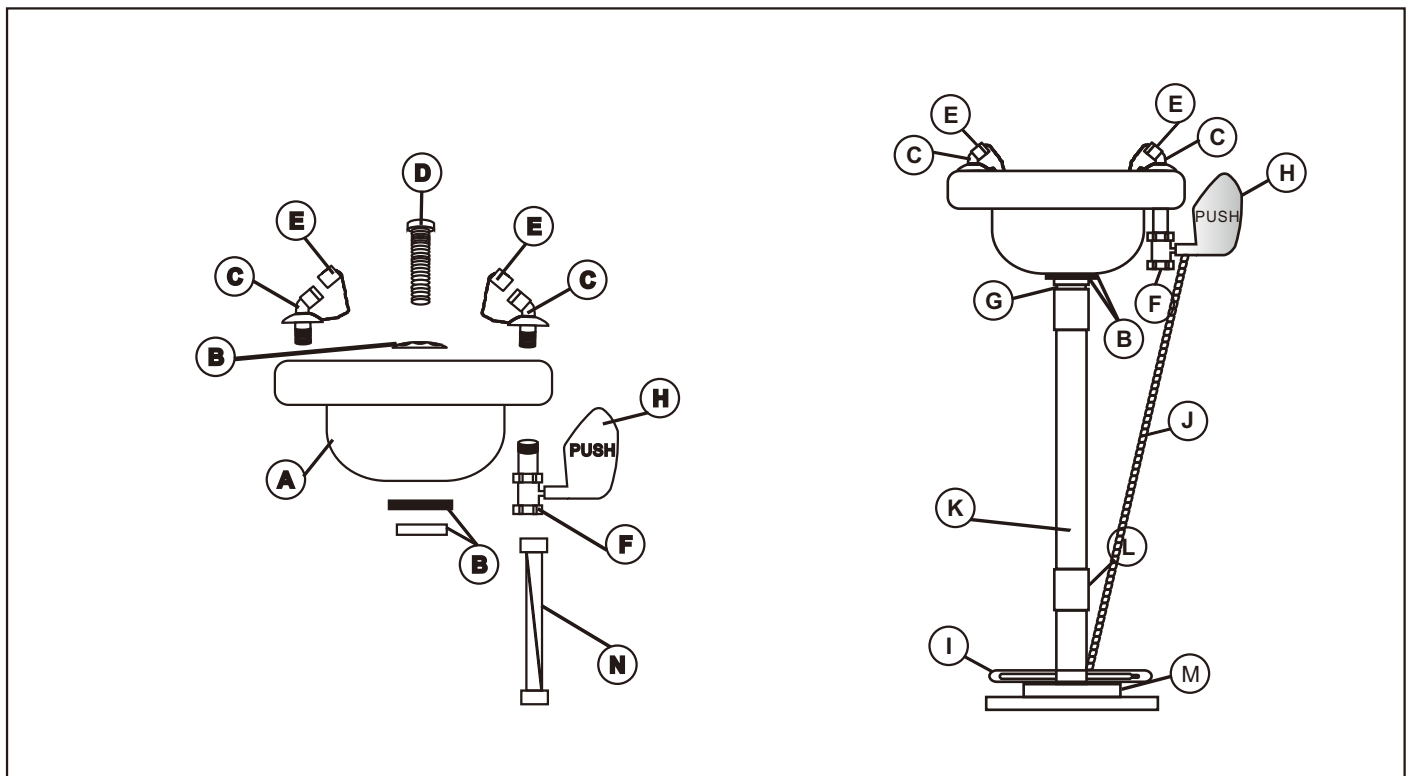

Eyewasher parts details

Eye Washer Assembly Instruction

Centurion Eye Washer are designed for easy assembly in the field. Essentially, these units are assembled from the “bottom up”, as described below :

1. Assemble PART 1 (BASE UNIT) to PART 2 (BASIN UNIT).
2. Connect PART 4 (Foot Panel chain) to Hand Panel small hole.
3. Connect the PART 1 (BASE UNIT) waste receptor to waster water outlet.
4. Connect PART 3 (HOSE) to water supply.
5. Secure entire unit to floor for stability.

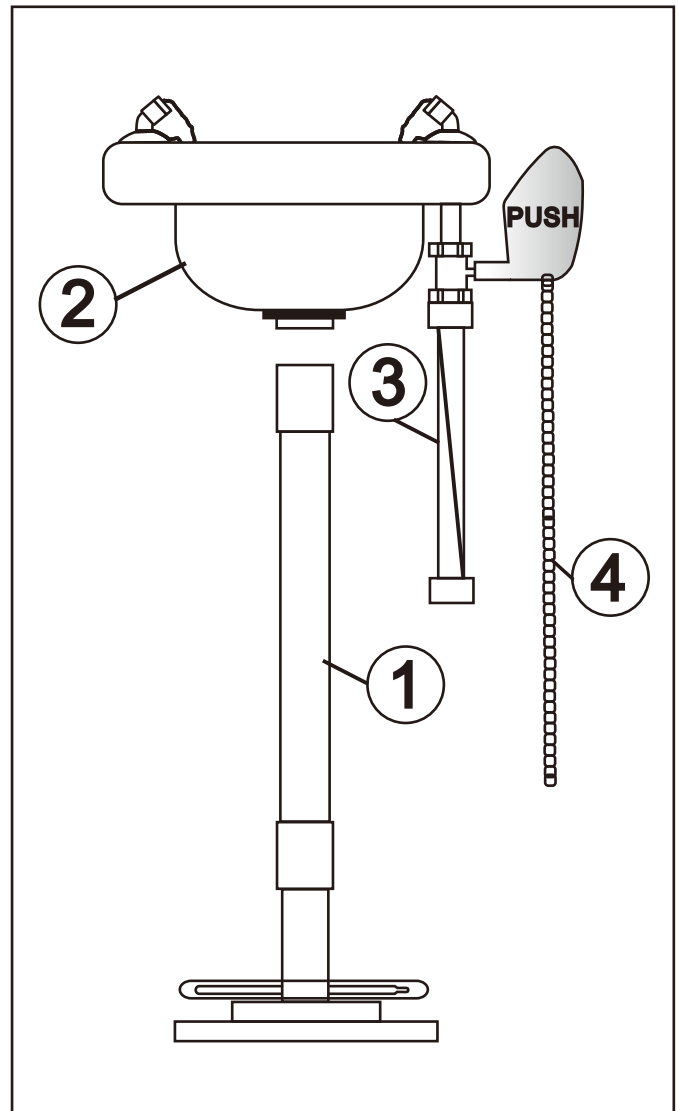

NOTES:

- All threads are tapered pipe and require pipe joint compound or Teflon tape to assure watertight connection
- If unit is furnished with corrosion resistant epoxy coating, care must be taken to avoid damaging finish during assembly. For best result, a strap wrench should be used.
- Test the entire unit for proper operation.